



DS-VS10-01

## VALVOLE DI SFOGO ARIA E ACCESSORI

*Air vent valves and accessories*

ART. 0015 0016	Valvola sfogo aria automatica. <i>Automatic air vent valve.</i>
ART. 0018	Valvola sfogo aria automatica, sfiato laterale. <i>Automatic air vent valve, side discharge.</i>
ART. 0019	Valvola sfogo aria automatica, attacco laterale. <i>Automatic air vent valve, side connection.</i>
ART. 0011	Tappo per radiatore con valvolina sfogo aria automatica. <i>Radiator cap with automatic air vent valve.</i>
ART. 0017	Valvola di ritegno per valvola di sfogo aria automatica. <i>Check valve for automatic air vent valve.</i>
ART. 0020 0022	Mini valvola a sfera FF e MF. <i>FF and MF mini ball valve.</i>
ART. 0012	Valvolina sfogo aria manuale in ottone. <i>Manual brass air vent valve.</i>
ART. 0013	Valvolina sfogo aria manuale con anello P.T.F.E. <i>Manual air vent valve with P.T.F.E. gasket.</i>
ART. 0014	Valvolina sfogo aria manuale. <i>Manual air vent valve.</i>
ART. 0001	Valvolina sfogo aria manuale girevole. <i>Turning manual air vent valve.</i>
ART. 0002	Valvolina sfogo aria manuale girevole in ottone. <i>Brass turning manual air vent valve.</i>
ART. 0004 0005	Tappo per termosifone. <i>Radiator cap.</i>
ART. 0006	Riduzione per termosifone. <i>Radiator reduction.</i>



0015



0016



0018



0019



0011



0017



0020



0022



0012



0013



0014



0001



0002



0004



0005



0006

**PRESTAZIONI**

Fluidi d'impiego	Acqua, soluzioni glicolate
Percentuale di glicole max	30%
Max pressione d'esercizio	10 bar
Max Temp. d'esercizio	80°C
Min Temp. d'esercizio	0°C

**PERFORMANCE**

Employed fluids	Water, antifreeze solutions
Max. percentage of glycol	30%
Max working pressure	10 bar
Max working temperature	80°C
Min working temperature	0°C

**MATERIALI**

Corpo	Ottone stampato: CW617N - UNI EN 12165
Coperchio	
Galleggiante	Polipropilene
Guarnizioni	Gomma NBR

**MATERIALS**

Body	Pressed brass: CW617N UNI EN 12165
Cap	
Float	Polypropylene
Gaskets	NBR rubber

**MATERIALI (solo per art. 0017)**

Corpo	Ottone trafilato: CW614N - UNI EN 12164
Molla	Acciaio inox: AISI 302
Componenti interni	Resina acetilica
O-Ring	Gomma NBR

**MATERIALS (only for art. 0017)**

Body	Extruded brass: CW614N UNI EN 12164
Spring	Stainless steel: AISI 302
Inside components	Acetal resin
O-Ring	NBR rubber

**0015**

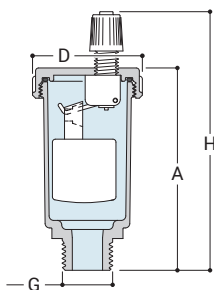

G	D	H	A
3/8"	37	85	67
1/2"	37	85	67

**0016**

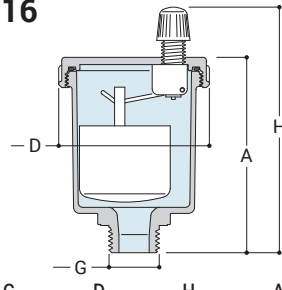

G	D	H	A
3/8"	50	80	64
1/2"	50	80	64
3/4"	50	82	66

**0018**

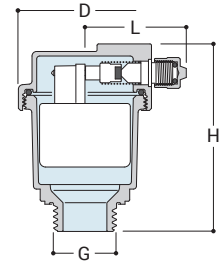

G	D	H	L
3/8"	45	63	33
1/2"	45	63	33

**0019**

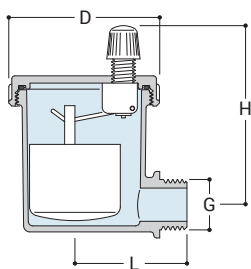

G	D	H	L
3/8"	47	53	34
1/2"	47	53	34

**0011**

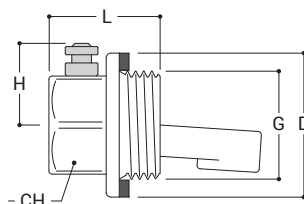

G	D	L	H	CH
1"	42	38	30	30
1 1/4"	52	33	33	41

**0017**

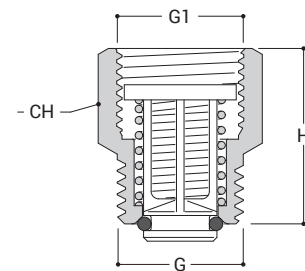

G	G1	H	CH
3/8"	3/8"	27	19
1/2"	1/2"	27	23

## Art. 0020, 0022

### PRESTAZIONI

Fluidi d'impiego	Acqua
Max pressione d'esercizio	10 bar
Max Temp. d'esercizio	90°C
Min Temp. d'esercizio	-10°C

### MATERIALI

Corpo	Ottone trafilato: CW614N - UNI EN 12164
Componenti interni	
Guarnizioni sfera	PTFE
O-Ring	Gomma NBR
Leva	Nylon 66 caricato vetro

### PERFORMANCE

Employed fluids	Water
Max working pressure	10 bar
Max working temperature	90°C
Min working temperature	-10°C

### MATERIALS

Body	Extruded brass: CW614N UNI EN 12164
Inside components	
Ball valve gaskets	PTFE
O-Ring	NBR rubber
Lever	Glass-charged nylon 66

## 0020

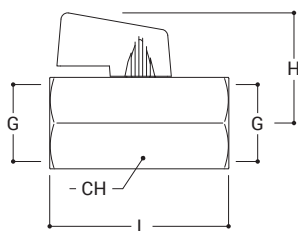

G	H	L	CH
3/8"	27	42	20
1/2"	29	47	24
3/4"	32	54	30

## 0022

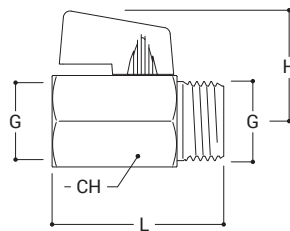

G	H	L	CH
3/8"	27	40	20
1/2"	29	45	24
3/4"	32	52	30

## Art. 0013, 0014

### PRESTAZIONI

Fluidi d'impiego	Acqua, soluzioni glicolate
Percentuale di glicole max	30%
Max pressione d'esercizio	10 bar
Max Temp. d'esercizio	80°C
Min Temp. d'esercizio	0°C

### MATERIALI

Corpo	Ottone trafilato: CW614N - UNI EN 12164
Volantino	Resina acetalica
Guarnizione (solo per art. 0013)	PTFE

### PERFORMANCE

Employed fluids	Water, antifreeze solutions
Max. percentage of glycol	30%
Max working pressure	10 bar
Max working temperature	80°C
Min working temperature	0°C

### MATERIALS

Body	Extruded brass: CW614N UNI EN 12164
Handweel	Acetal resin
Gasket (only for art. 0013)	PTFE

## 0013

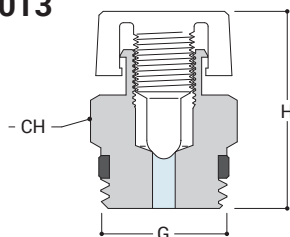

G	H	CH
1/4"	28	13
3/8"	28	17
1/2"	28	21

## 0014

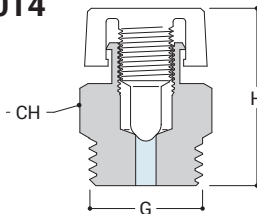

G	H	CH
1/8"	28	11
1/4"	28	13
3/8"	28	17
1/2"	28	23

## Art. 0012, 0001, 0002

### PRESTAZIONI

Fluidi d'impiego	Acqua, soluzioni glicolate
Percentuale di glicole max	30%
Max pressione d'esercizio	10 bar
Max Temp. d'esercizio	110°C
Min Temp. d'esercizio	0°C

### MATERIALI

Corpo	Ottone trafilato: CW614N - UNI EN 12164
Componenti interni	
Elementi di tenuta	Gomma EPDM

### PERFORMANCE

Employed fluids	Water, antifreeze solutions
Max. percentage of glycol	30%
Max working pressure	10 bar
Max working temperature	110°C
Min working temperature	0°C

### MATERIALS

Body	Extruded brass: CW614N UNI EN 12164
Inside components	
Seal elements	EPDM rubber

## 0012

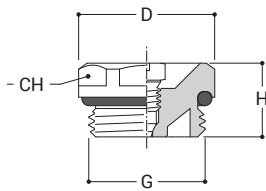

G	D	H	CH
1/2"	24	13	22

## 0001

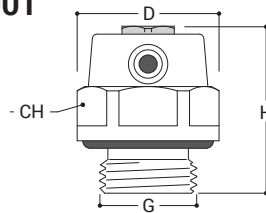

G	H	D	CH
1/8"	19	16	14
1/4"	19	16	14
3/8"	19	24	22
1/2"	19	24	22

## 0002

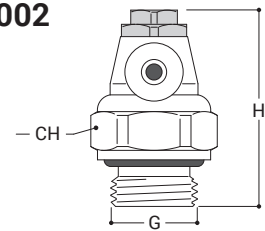

G	H	CH
1/8"	24	14
1/4"	24	17
3/8"	24	19
1/2"	24	22

## Art. 0004, 0005, 0006

### PRESTAZIONI

Fluidi d'impiego	Acqua, soluzioni glicolate
Percentuale di glicole max	30%
Max pressione d'esercizio	8 bar
Max Temp. d'esercizio	110°C
Min Temp. d'esercizio	5°C
Momento torcente consigliato per la chiusura	35 Nm

### MATERIALI

Corpo	Ottone trafilato: CW614N - UNI EN 12164
O-Ring	Gomma EPDM

### PERFORMANCE

Employed fluids	Water, antifreeze solutions
Max. percentage of glycol	30%
Max working pressure	8 bar
Max working temperature	110°C
Min working temperature	5°C
Suggested tightening torque	35 Nm

### MATERIALS

Body	Extruded brass: CW614N UNI EN 12164
O-Ring	EPDM rubber

## 0004

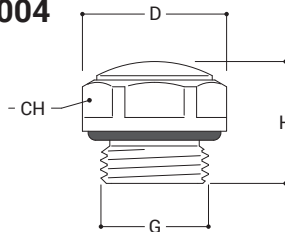

G	H	D	CH
3/8"	17	24	22
1/2"	17	24	22

## 0005

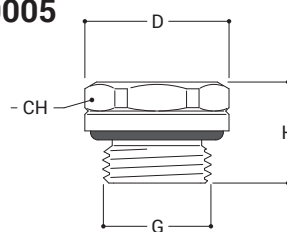

G	H	D	CH
3/8"	13	24	22
1/2"	13	24	22

## 0006

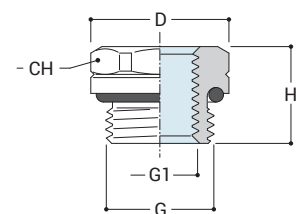

G	G1	H	D	CH
1/2"	1/8"	13	24	22
1/2"	1/4"	13	24	22
1/2"	3/8"	13	24	22
3/4"	1/4"	14	30	25
3/4"	3/8"	14	30	25
3/4"	1/2"	14	30	25

